

HEAVY DUTY WIDE STRAP HINGE

316 STAINLESS STEEL



Import



Precision
Cast



Suncor
Exclusive

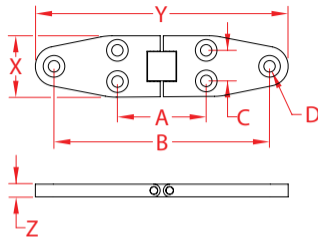

ITEM	A	B	C	D	X (height)	Y (length)	Z (width)	WT (lb)	PACKAGING TYPE	EACH (qty)	INNER (qty)	CARTON (qty)	UPC
HEAVY DUTY													
S3832-0001	1.40"	3.40"	N/A	0.18"	1.11"	4.00"	0.20"	0.17	POLYBAG	1	1	100	791506058212
S3832-0002	2.07"	4.85"	0.83"	0.20"	1.63"	6.00"	0.20"	0.38	POLYBAG	1	1	100	791506058229

NOTE:

USE 4 OR 6 #10 FASTENERS. EXCLUSIVE FLUSH DESIGN CAN MOVE 360 DEGREES. ONE HALF FOLDS FLAT ON TOP OF OTHER HALF.

IDEAL FOR TABLES, DOORS AND OTHER APPLICATIONS WHERE RECESSED HINGES ALLOW A TOTALLY FLAT SURFACE.

REFERENCE "FASTENER MATCHING CHART" FOR COMPATIBLE FASTENERS.

ALL DIMENSIONS ARE NOMINAL (+/- 3%) AND ARE SUBJECT TO CHANGE WITHOUT NOTICE.